

BENETTI

SKU# 230187

Rated Voltage 220-240V~ 50Hz

Thank you for purchasing this quality Lucci product. To ensure correct function and safety, please read and follow all instructions carefully before assembly, installation and use of this product. Please keep instructions for future reference.

Warranty

- This light fitting is covered by a 5 year warranty. The warranty is from date of purchase, not the date of installation.
- If the fitting is not assembled and installed by a licensed electrician the warranty will be void.
- Please retain proof of purchase and evidence of installation by a licensed electrician.
- Warranty will be void if there is any damage due to improper usage or modification to the fitting.
- Failure to comply with the instructions in this manual may increase the risk of damage or injury and will void warranty.

Installation requirements

- Must be installed by a licensed electrician.
- All wiring and installation of the light fitting must adhere to local and national wiring rules. eg. AS/NZS 3000:2007/Amendment 2:2012 Electrical installations.
- This fitting is a Class I product and must be earthed.
- Do not exceed the maximum wattage rating.
- Energy saving LED or CFL globes must be used with this product.
- Select a suitable location for installation;
 - The mounting point must support 2 times the weight of the fitting.
 - This fitting is rated IP44 which is protected against splashing. This must be maintained during installation.
- The fitting must not be used if the shade has been damaged or cracked.
- Take care not to pull any electrical wires during unpacking as this may damage the connection.
- Lay out all the components on a smooth surface and make sure there are no components missing before assembling. If parts are missing, return the complete product to the place of purchase for inspection or replacement.
- Check whether the fitting has been damaged during transport. Do not operate/install any product which appears damaged in any way. Return the complete product to the place of purchase for inspection, repair or replacement.
- Ensure power to the circuit you are working on has been switched OFF before commencing any electrical work.

Installation directions

1. Remove all packaging material from the product and be careful not to throw away accessories that may be hidden within the packaging material. Remove the frame and glass from the fitting by loosening the 4 screws at each corner with the allen key provided. Use the back plate as a template to mark the screw positions onto the wall. (figure 1) **NOTE: It is recommended that a non-corrosive bead of silicone be applied before screwing to the wall ensuring that no water can run down into the cabling.**
2. Install the back plate onto the wall by using appropriately sized mounting screws and anchors. Ensure the mounting screws and anchors used are suitable for the mounting surface and the surrounding environment. (figure 2) Connect the mains supply wire to the terminal block. Ensure the wires are secure and no bare wires are exposed.

Mains Supply Wire

Earth – Yellow/Green
 Neutral – Blue or Black
 Live – Brown or Red

Fitting Wire

Yellow/Green
 Blue 
 Brown

3. Install globes (not included) into the lamp holders. Do not exceed the maximum wattage rating. (figure 3)
4. Energy saving globes must be used, eg. CFL or LED globes only. (figure 4)
5. Install the glass and frame onto the back plate by tightening the screws in each corner with the allen key provided. (figure 5)
6. Make any final adjustments to the fitting and check that all parts are done up tightly before turning on. (figure 6)

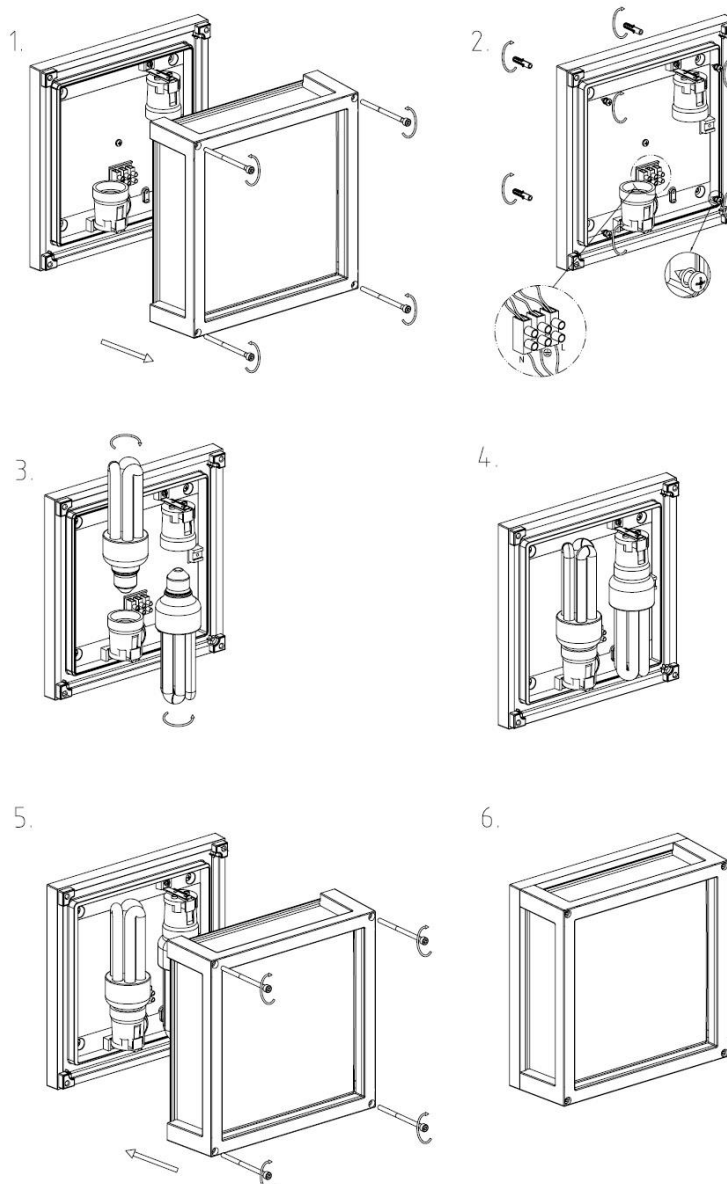

Safety tips

- Always ensure the power is OFF and the fitting has cooled down before performing any maintenance, cleaning, changing the globe or making any adjustment to the fitting.
- To avoid injury or damage to the fitting, ensure that power leads and screws are secure before connecting the power.
- Handle the fitting and/or shade with care to avoid any damage or breakage.
- Ensure that the fitting does not come in contact with corrosive chemicals, etc.
- To clean, wipe with a damp clean cloth. Never soak the fitting with water.

Specifications

| | |
|---------------|--|
| SKU # | 230187 |
| Rated Voltage | 220-240V~ 50Hz |
| Rated Wattage | 30W Max. (2 x Max. 15W – Energy saving LED or CFL globes only) |
| Lamp Holder | ES / E27 |
| IP Rating | IP44 |
| Weight | 2.8kg |
| Dimensions | L:250mm W:250mm H:96mm |