

Installation Instructions
SKU# 050186, 050187
(LD-D82515-2BK, LD-D82515-2WH)
Rated Voltage 220-240V, 50Hz

PLEASE READ ALL INSTRUCTIONS CAREFULLY BEFORE USING THE PRODUCT AND KEEP THE INSTRUCTIONS FOR FUTURE REFERENCE.

WARNING - to reduce the risk of fire, electrical shock or injury to persons or property, please follow the guideline below for safe use and installation.

INSTALLATION REQUIREMENTS:

- Must be installed by a licensed Electrician.
- Must be installed according to the current wiring rules AS/NZS3000.
- Do not exceed the maximum wattage rating.
- Suitability for use “indoors”.
- The mounting point must be able to support 4 times the weight of the fitting.

INSTALLATION DIRECTIONS:

- Take care not to pull any wires during unpacking as a bad connection may occur.
 - Level all the components on a smooth surface and make sure there is no component missing before assembly.
 - Check whether the fitting has been damaged during transport. Do not operate/install any product which appears damaged in any way. Return the complete product to the place of purchase for inspection, repair or replacement.
 - Ensure all power connection is off for your own safety.
 - Select a suitable location for installation. Ensure the fitting is not installed next to any air vents and is not in any moist or damp areas. The mounting point must be able to support 4 times the weight of the fitting.
1. Use the mounting bracket to mark holes onto the wall.
Drill holes into the wall and put the plastic anchors (B) into the holes.
Install the screws (D) and washers (C) provided with the mounting bracket onto the mounting bracket.
Secure the mounting bracket onto the wall via screws provided.
Ensure the screws used are suitable for the mounting surface.
 2. Connect the mains supply wire to the light fitting using the terminal block provided. Ensure that the wires are secure and no bare wires are exposed.

Mains Supply Wire

Earth – Yellow/Green
Neutral – Blue or Black
Live – Brown or Red

Fitting Wire

Yellow/Green ⊕
Blue
Brown

3. Attach the fitting to the wall and secure it on mounting bracket via tightening the finial.
Take note of the directional label.
4. Attach the crystals (A).
5. Remove the plastic wrapping from the shade before using.
Secure the lamp shade to the lamp holders via tightening the lamp holder rings.
6. Install light bulbs (not included).
7. Turn on power and enjoy your new lighting product

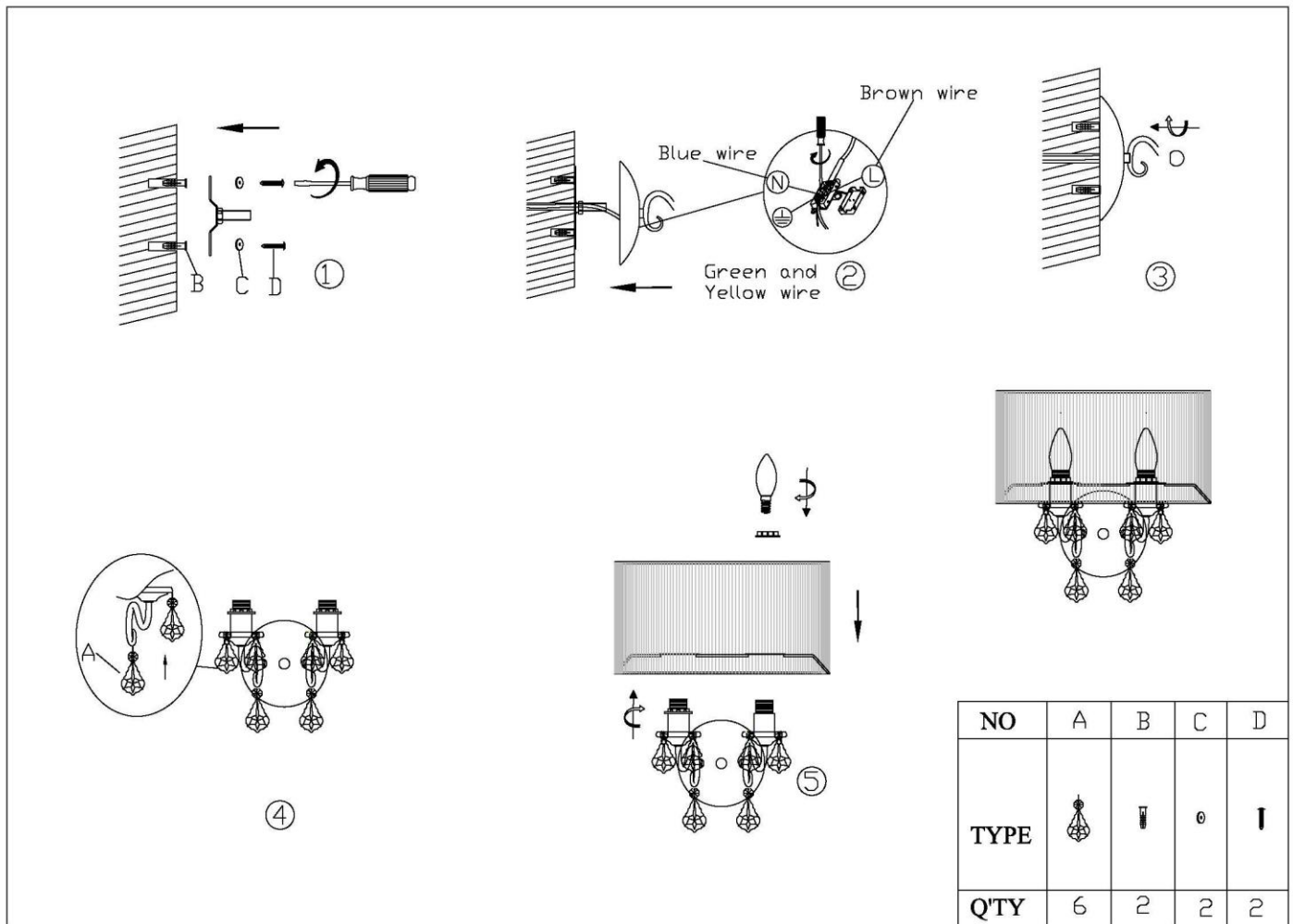

TIPS:

1. To avoid injury or damage to the fitting, ensure that power leads and screws are secure before connecting the power.
2. Handle the fitting and cover/shade with care to avoid breakage.
3. When changing or cleaning bulbs, turn OFF power and allow to cool. Do not touch bulbs with bare hands, use gloves or a tissue.
4. Find a suitable location away from liquids and hazards.
5. Ensure that the fitting does not come in contact with corrosive chemicals, etc.
6. To clean, wipe with a damp clean cloth. Never soak the fitting with water.

SPECIFICATIONS:

| SKU # | MODEL # | RATED VOLTAGE | RATED WATTAGE | LAMP HOLDER |
|--------|---------------|---------------|---------------|-------------|
| 050186 | LD-D82515-2BK | 220-240V~50Hz | 2x Max. 40W | E14 |
| 050187 | LD-D82515-2WH | 220-240V~50Hz | 2x Max. 40W | E14 |